

SUPPRESSALL FS2-MAX SAFETY PIN SYSTEM

Important information: The SUPPRESSALL FS2-MAX is equipped with 2 metal pins. The “R-Pin”(1) is a safety device that is designed to hold the “Igniter Pin” (2) in-place, during transportation and storage.

When the decision is made to deploy the SUPPRESSALL FS2-MAX:

1.) Pull the “R-Pin” first (1st), pulling it straight out and removing it from the handle of the unit. **2.) Pull the “Igniter Pin”,LAST (2nd)** to activate that unit. **The red light will go on when the Igniter pin is pulled.**

CAUTION, THE AEROSOL IS HOT!! YOU MUST DEPLOY THE UNIT!

YOU ONLY HAVE 8 SECONDS AFTER THE "IGNITER PIN" IS PULLED BEFORE THE UNIT DEPLOYS!

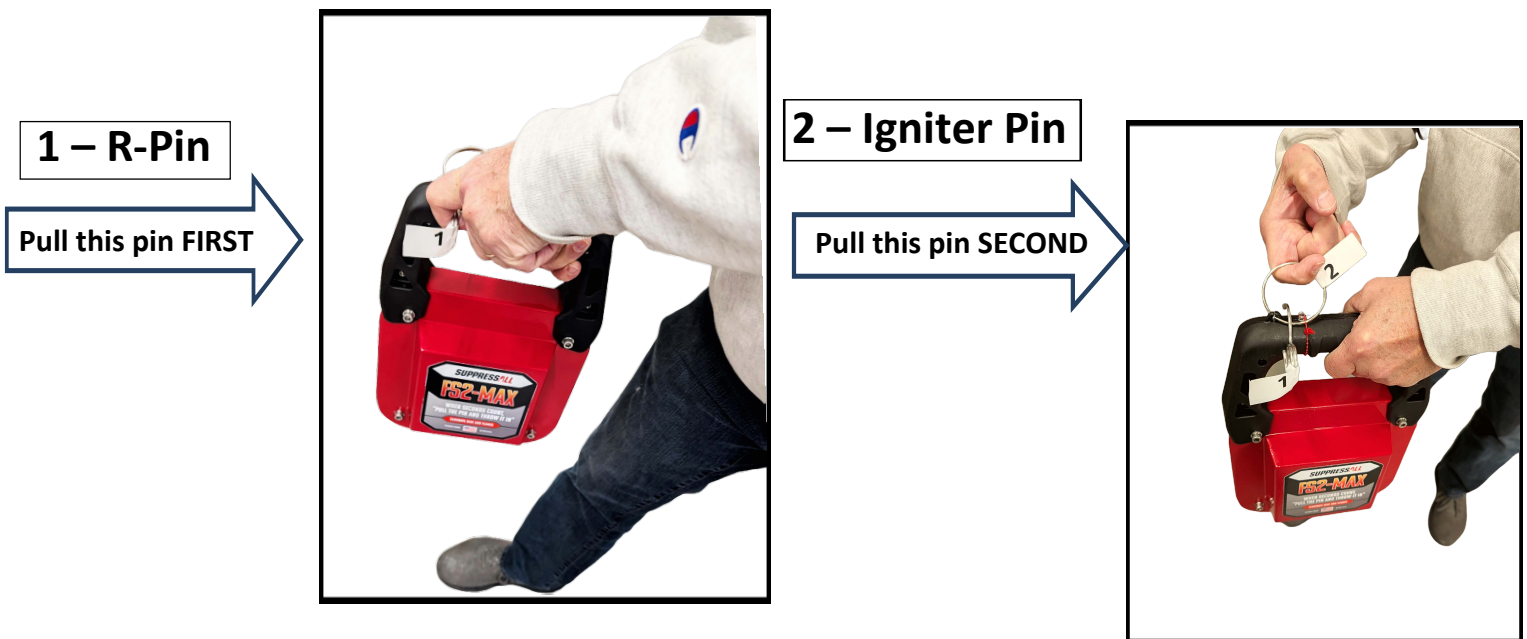

Pulling the pins in the incorrect order will cause the SUPPRESSALL FS2-MAX to fail. It will not deploy. REMEMBER: PULL THE TAB LABELED ONE(1) FIRST, THE PULL THE TAB LABELED TWO(2).

Pulling the pins in the incorrect order will void your warranty.

Please read this memo and the manual that is included with your SUPPRESSALL FS2-MAX

Fire Suppression Industries, LLC 1225 Carnegie St. Unit 102 Rolling Meadows, IL 60008